

SAMPLE PLAN
NOT AUTHORIZED FOR CONSTRUCTION

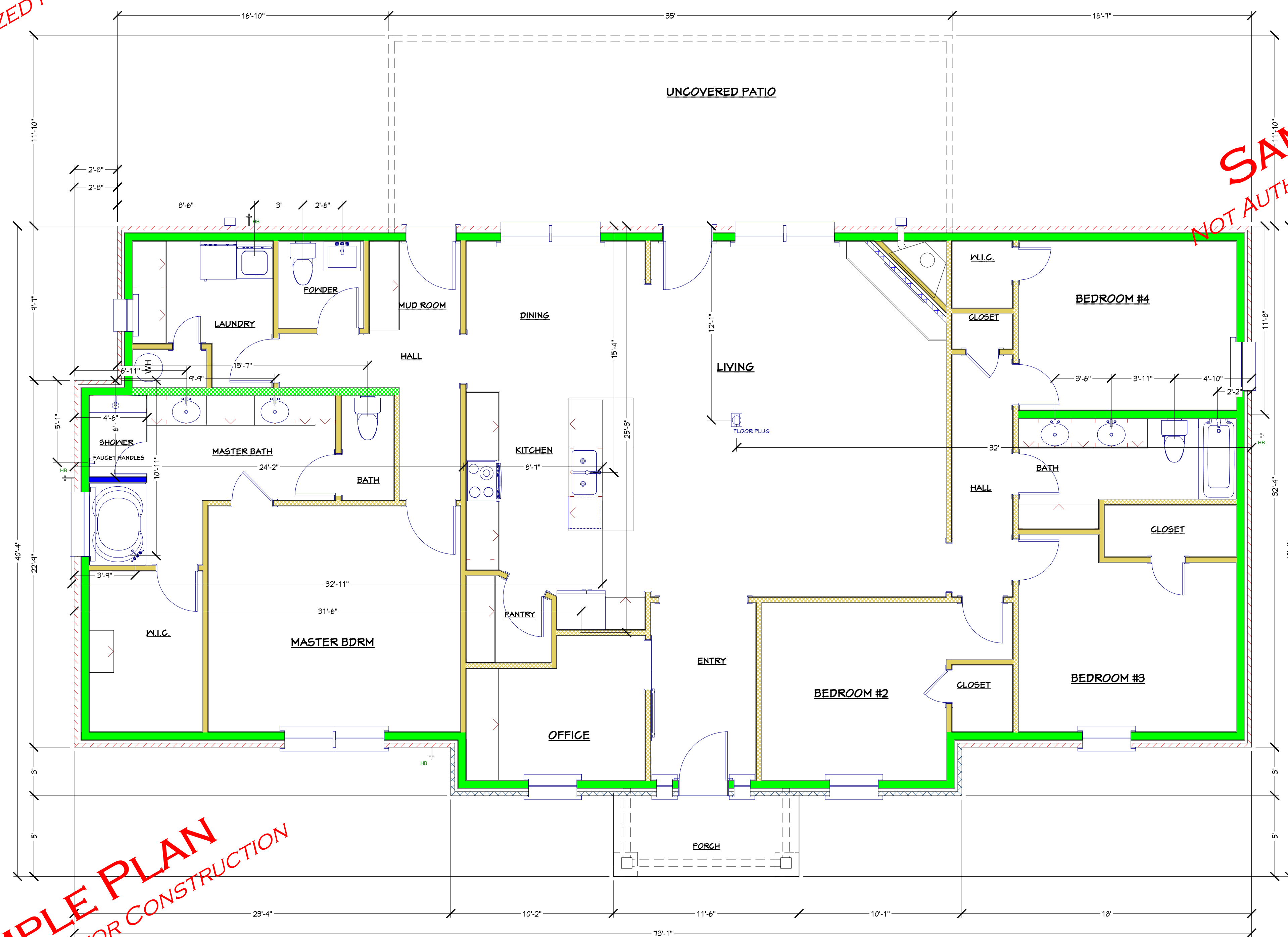

SAMPLE PLAN
NOT AUTHORIZED FOR CONSTRUCTION

ROUGH-IN PLAN

Fixture Location
SCALE: 1/4" = 1'

All Dimensions are Taken from Outside Face of Brick/Stone Ledge & Interior Wall Centers

Note to Contractor:
I. Whole House to be electric.
II. Master bath will have tiled shower.
III. Secondary baths will have tub with tile surround.
IV. HB - Exterior Hose Bib.

| FIXTURE SCHEDULE | | | |
|------------------|-----|-------------------------|----------------------------------|
| 3D PERSPECTIVE | QTY | DIMENSIONS | DESCRIPTION |
| | 3 | 30X36X31" | ELONGATED TOILET |
| | 4 | 20 3/4X19 7/16X14" | BATH - OVAL SINK (20 3/4X14") |
| | 1 | 27X29 5/8X42" | DRYER (GAS) |
| | 1 | 27X27 1/2X42" | WASHER |
| | 1 | 36X30X66" | SIDE-BY-SIDE REFRIGERATOR 2 |
| | 1 | 61X42X26 15/16" | DOUBLE-CURVE |
| | 1 | 60X28X29 1/4" | STANDARD TUB 2 (60W) |
| | 1 | 30X26 1/8X35 3/4" | FLAT TOP RANGE (30W) |
| | 1 | 23 5/16X23X30 1/2" | DISHWASHER (INTEGRATED) |
| | 1 | 33 3/16X22X21 1/16" | KITCHEN - DOUBLE UNDERMOUNT SINK |
| | 1 | 27X22X39 15/16" | PEDESTAL SINK |
| | 1 | 5 3/16X9 7/16X9 9/16" | RETRO HEAD |
| | 1 | 11 7/8X1 1/16X5 13/16" | BATHTUB FAUCET |
| | 1 | 6 11/16X3 11/16X1 1/16" | HOOP HANDLE |
| | 1 | 78X2 9/16X84 3/4" | X-BRACE |
| | 1 | 35 3/4X20 5/8X46 3/16" | ISLAND CAB-3609 |
| | 2 | 24 1/2X21 1/2" | MEDIUM ELEC WH |
| | 2 | 8X6X8" | DRYER VENT |
| | 4 | 1 5/16X3 7/16X3 5/8" | HOSE BIB |

SAMPLE PLAN
NOT AUTHORIZED FOR CONSTRUCTION

NOTICE & DISCLAIMER
UNDER NO CIRCUMSTANCES WILL TRACY'S CUSTOM HOMES BE LIABLE FOR ANY DAMAGES, WHETHER ARISING FROM TORT OR CONTRACT, INCLUDING LOSS OF DATA, LOST PROFITS, COST OF COVER, OR OTHER SPECIAL, INCIDENTAL, CONSEQUENTIAL OR INDIRECT DAMAGES ARISING OUT OF THE USE OF THESE DRAWINGS.

SAMPLE PLAN
YOUR RESIDENCE
ROUGH-IN

2918 ANDREW DR
FARMERSVILLE, TX 75442
(903) 274-6022 CELL
sales@tracyscustomhomes.com
www.tracyscustomhomes.com

